

DOLBY ATMOS®
Manufactured under license from Dolby Laboratories. Dolby, Dolby Audio, Dolby Vision, Dolby Atmos and the double -D symbol are trademarks of Dolby Laboratories.

★ What is DOLBY ATMOS®?

Dolby Atmos® transports you from the ordinary into the extraordinary with breathtaking, moving audio that fills your room and flows above and around you.
Dolby Atmos gives you amazing experience you have never heard before by overhead sound, and all the richness, clarity, and power of Dolby sound.

★ Using DOLBY ATMOS®:

- DOLBY ATMOS is only available in HDMI IN and HDMI OUT (ARC) mode.
For the details of the connection, please refer to "HDMI Connection".
1. To use Dolby Atmos® in HDMI 1 /HDMI 2 / HDMI ARC mode, your TV has to support Dolby Atmos®.
 2. Make sure that "No Encoding" is selected for bitstream in the digital audio output of the connected external device (e.g. Blu-ray DVD player, TV etc.).
 3. While entering Dolby Atmos / Dolby Digital Plus format, the soundbar will show DOLBY ATMOS / DOLBY SURROUND.
 4. Set the audio output sampling rate to 192 kHz if you can adjust it.
- This sound bar supports 4K Pass through and DOLBY VISION. When you play a disc which supports 4K video signal, the signal can be delivered to your TV.

★ Note:

- The full Dolby Atmos experience is only available when the Soundbar is connected to the source via a HDMI 2.0 cable.
- The Soundbar will still function when connected via other methods (such as a Digital Optical cable) but these are unable to support all of the Dolby features. Given this, our recommendation is to connect via HDMI, in order to ensure full Dolby support.

Important Safety Instructions

Thank you for purchasing the CASB360 Soundbar.
Please read this user manual carefully and keep for future reference.

Warning

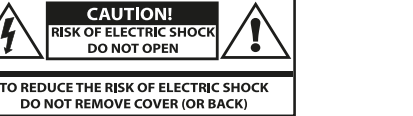

Caution:

To reduce the risk of electric shock, do not dismantle the product and do not expose the apparatus to rain or moisture. No user-serviceable parts inside. Refer servicing to qualified personnel only

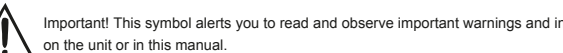
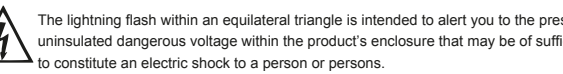

Notice:

- This appliance is not intended for use by persons (including children) with reduced physical sensory or mental capabilities, or lack of experience and knowledge, unless they have been given supervision or instruction concerning use of the appliance by a person responsible for their safety. Children should be supervised to ensure that they do not play with the appliance.
1. To prevent possible hearing damage, do not listen at high volume levels for long time periods or suddenly.
 2. Never use the device unsupervised! Switch off the device whenever you are not using it, even if not using it only for a short while.
 3. The appliance is not intended to be operated by means of an external timer or separate remote control system.
 4. If the supply cord is damaged, it must be replaced by the manufacturer, its service agent or similarly qualified persons in order to avoid a hazard.
 5. Before operating this system, check the voltage of this system to see if it is identical to the voltage of your local power supply.
 6. The unit should not be impeded by covering the ventilation opening with items such as newspaper, table-cloths, curtains etc. Make sure that there are at least 20 cm of space above and at least 5 cm of space on each side of the unit.
 7. The apparatus must not be exposed to dripping or splashing liquid, no objects filled with liquids such as vases, should be placed on the apparatus.
 8. To prevent fire or shock hazard, do not expose this equipment to direct heat, rain, moisture or dust.
 9. Do not position this unit near any water sources e.g. taps, bathtubs, washing machines or swimming pools. Ensure that you place the unit on a dry, stable surface.

10. Do not place this unit close to a strong magnetic field.
11. Do not place the unit on a amplifier or receiver.
12. Do not place this unit in a damp area as the moisture will affect the life of electric components.
13. Do not attempt to clean the unit with chemical solvents as this might damage the finish. Wipe with a clean, dry or slightly damp cloth.
14. When removing the power plug from the wall outlet, always pull directly on the plug, never pull on the cord.
15. Depending on the electromagnetic waves used by a television broadcast, if a TV is turned on near this unit while it is also on, lines might appear on the LED TV. Neither this unit nor the TV is malfunctioning. If you see such lines, keep this unit well away from the TV set.

Important Maintenance Instructions

1. Read, keep and follow all instructions. Heed all warnings.
2. Avoid dropping. Do not disassemble.
3. Protect the power cord from being walked on or pinched particularly at plugs, convenience receptacles or at the point where they exit from the apparatus.
4. Do not use the device outdoors during thunderstorms, Unplug this apparatus during lightning storms or when unused for long periods of time.
5. Refer all servicing to qualified service personnel. Servicing is required when the apparatus has been damaged in any way, for example, when the power-supply cord or plug is damaged, liquid has been spilled or objects have fallen into the apparatus, the apparatus has been exposed to rain or moisture, does not operate normally, or has been dropped.
6. In order to disconnect the apparatus from the AC power completely, the AC plug must be removed from the AC outlet completely.

Preparation for Use

Unboxing and Set Up

- Remove the Soundbar from the carton and remove all packing material from the Soundbar. Save the packing material, if possible, in case the Soundbar ever needs to be serviced or transported. The original carton and packing material is the only safe way to pack your Soundbar to protect it from damage in transit.
- Remove any descriptive labels or stickers on the front or top of the cabinet. Do not remove any labels or stickers from the back or bottom of the cabinet.
- Place your Soundbar on a level surface such as a table, desk or shelf, convenient to an AC outlet, out of direct sunlight, and away from sources of excess heat, dirt, dust, moisture, humidity, or vibration.
- Unwind the Line cord connecting the AC adapter and extend it to its full length.

Protect Your Furniture

This model is equipped with non-skid rubber 'feet' to prevent the product from moving when you operate the controls. These 'feet' are made from non-migrating rubber material specially formulated to avoid leaving any marks or stains on your furniture. However certain types of oil based furniture polishes, wood preservatives, or cleaning sprays may cause the rubber 'feet' to soften, and leave marks or a rubber residue on the furniture. To prevent any damage to your furniture we strongly recommend that you purchase small self-adhesive felt pads, available at hardware stores and home improvement center everywhere, and apply these pads to the bottom of the rubber 'feet' before you place the unit.

Power Source

This Soundbar is designed to operate in 110V ~240V ~ 50Hz/60Hz

Product Diagram

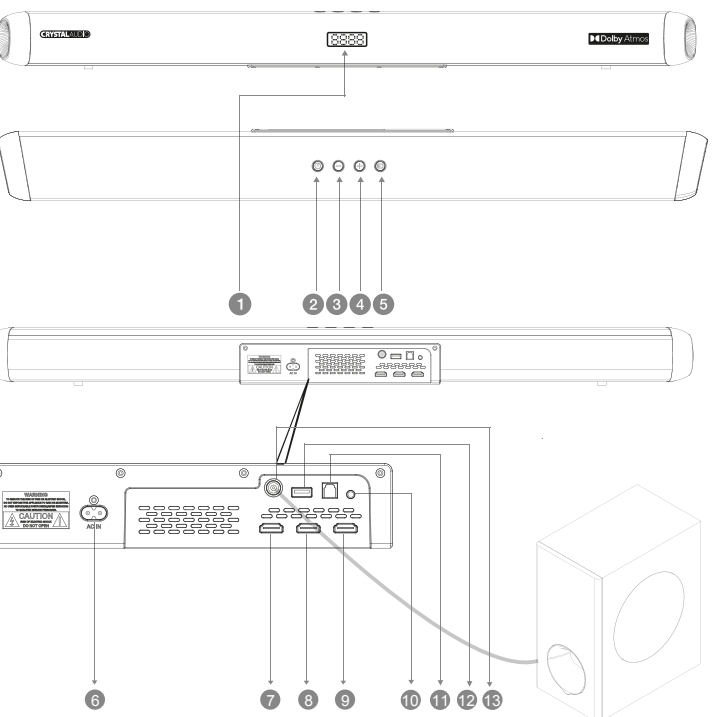

1. DISPLAY PANEL
2. Standby-on: Switch the Soundbar On or to standby.
3. Volume: Decrease the volume.
4. Volume: Increase the volume.
5. INPUT: Select an input source for the Soundbar.
6. AC IN: Connect to power supply.
7. HDMI IN 2: Connect to HDMI OUT of TV/Satellite/ Network/Set-top box/BD/Blue Ray DVD/DVD player.
8. HDMI IN 1: Connect to HDMI OUT of TV/Satellite/Network/ Set-top box/BD/Blue Ray DVD/DVD player.
9. HDMI OUT (ARC): Connect to HDMI (ARC)/HDMI IN on TV.
10. AUX: Auxiliary Audio input from Mp3/Phone/set-top box devices.
11. OPTICAL: Connect to an optical audio output on TV or digital devices.
12. USB PORT: Audio input from a USB storage device. Upgrade software of this product.
13. WOOFER PORT: Connect to the wired subwoofer.

Remote Control

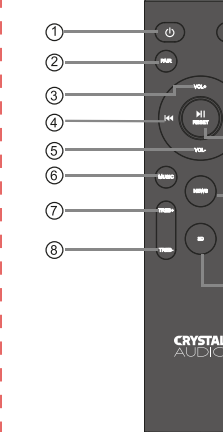

1. Power: Press to switch the soundbar on/off or standby mode.
2. PAIR: long-press pair button more than 2 seconds to connect and disconnect last device.
3. VOL+: to increase the volume.
4. Previous button: Skip to the previous track in USB & BT mode.
5. VOL-: to decrease the volume.
6. Music button: to select and activate the music EQ effect and mode.
7. Treble-up button: to increase the treble volume.
8. Treble-down button: to decrease the treble volume.
9. Mute button: To temporarily turn off the sound. Press the button again to turn the sound back on.
10. Source input button: to select an input source for playback:
ARC: sound from connected HDMI ARC device
Hd 1: sound from connected HDMI 1 port
Hd 2: sound from connected HDMI 2 port
BLUE: sound from connected Bluetooth drive.
AUX: sound from connected Auxiliary Line-in
USB: sound from connected USB driver
OPT: Sound from connected Digital Optical device.
11. Next button: Skip to the next track in USB & BT mode.
12. Hi Play/Pause button: Start, pause or resume play in USB & BT mode.
Reset button: Press and hold the button more than 2 seconds to restore factory default settings.
13. Movie button: to select and activate the movie EQ effect and mode.
14. News button: to select and activate the news voice EQ effect and mode.
15. Bass+ button: To increase the bass.
16. Bass- button: To decrease the bass.
17. 3D button: to select and activate the 3D EQ effect and mode.

Operating range of the remote control

- When the unit is mounted on a wall, point the remote control at the remote sensor as seen below. The provided Remote Control allows the unit to be operated from a distance.
- Even if the Remote Control is operated within the effective range 32.8 feet (10m), remote control operation may be impossible if there are any obstacles between the unit and the remote control.
- If the Remote Control is operated near other products which generate infrared rays, or if other remote controlled devices using infrared are used near the unit, it may operate incorrectly. Conversely, the other products may operate incorrectly.

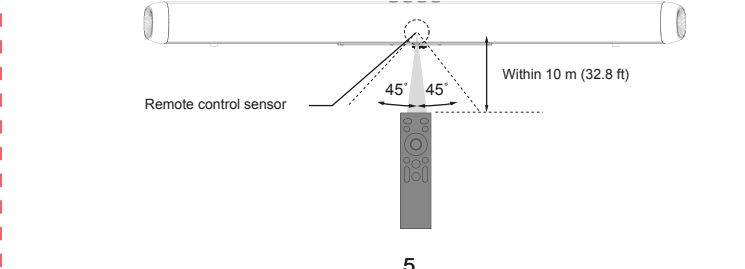

Positioning the Soundbar

Table Placement

- Place the soundbar horizontally on a solid surface such as a TV unit or shelves and align it centrally with the TV screen.
- For best sound output and good airflow around the soundbar, place your soundbar and subwoofer as shown on the right.

Wall Mount Installation

1. Open 4 holes in the wall referring to the iron bracket for wall mounting on the device, spacing the holes in the wall corresponding to the distance between the soundbar pads.
2. Fix the plastic anchor in the 4 holes of the wall mounting bracket.
3. Fix the screws on the plastic anchor and tighten the screws to ensure that the wall mounting bracket will not shake.
4. After fastening the screws, put the soundbar pads into the extension of the wall mounting bracket

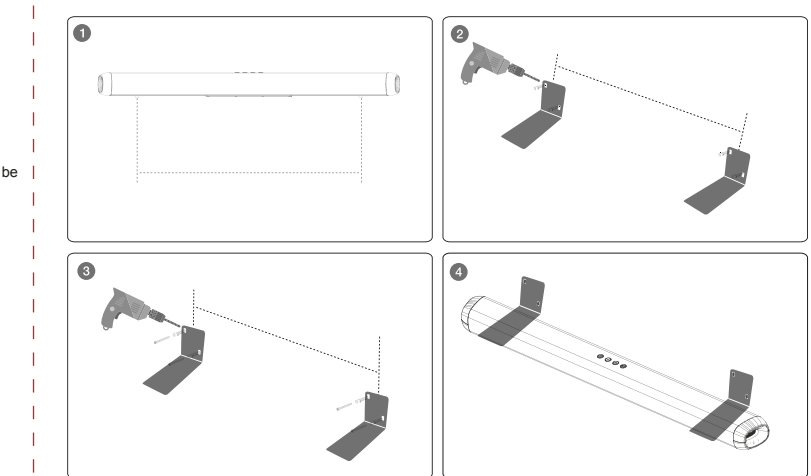

Soundbar Set-up

- Before connecting the AC power cord, ensure you have completed all other connections.
- Risk of product damage! Ensure that the power supply voltage corresponds to the voltage printed on the back or the underside of the unit.
- Connect the mains cable to the AC IN of the unit and then into a mains socket.
- Power cord quantity and plug type vary by region.

Basic Operation

1. Press the power button on either the remote control or the soundbar to turn on the soundbar.
2. Switch on the connected device (such as TV, playback devices, game console etc).
3. Press the input button on either the remote control or the soundbar to select your desired input source

Input Source	Description
HDMI 1 & HDMI 2	Sound from a connected device (via HDMI IN port)
ARC / OPTICAL	Audio from TV (via HDMI ARC port or OPTICAL jack)
AUX	Sound from a connected device (via AUX port)
BLUETOOTH	Sound from a Bluetooth connected device
USB	Sound from a USB storage device

Power ON and OFF

1. Plug in the power cord with one side to AC IN on soundbar and the other side to an AC wall outlet (see the following diagram). When you connect the soundbar to the main socket, the unit will be in STANDBY mode.
2. Switch on the soundbar by short-pressing the button on soundbar or on remote controller, then it will display WELCOME from right to left. After 12s, the default input mode will automatically appear on the screen.
3. Press and hold the button on soundbar or on the remote controller for 2 seconds to switch it off, and then disconnect the main plug from the main socket if you want to switch the unit off completely.

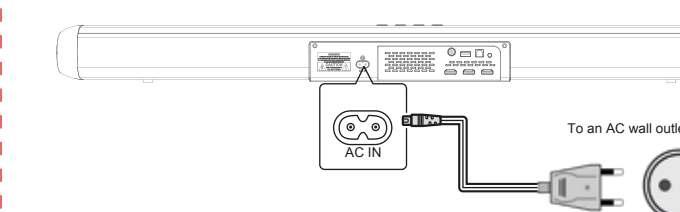

Select Equalizer (EQ) Effect

Select predefined sound modes to suit your video or music
Press the EQ button on the remote control to select your desired preset equalizer effects:
Movie/Music/News/3D:

Music mode	Enhances the treble and adds greater depth to the music.
Movie mode	Intensifies the bass and enhances the clarity of dialogue.
News mode	Enhances the clarity of voices. Suitable for watching TV shows and news.
3D mode	Enhances background music and full range to be sports effect

Adjust the Volume

Press Vol+/Vol- (Volume) to increase or decrease a volume level.
• To mute sound, press Mute.
• To restore the sound, press Mute again or press Vol+/Vol- (Volume).

Adjust the Bass/Treble Level

Adjust the Bass Level
• Press the BASS+ / BASS- button on the remote control to activate bass level setting.
» The display will show +S / b -S.

Adjust the Treble Level

• Press the TREB+ / TREB- button on the remote control to activate treble level setting.
» The display will show T +S / T -S.



www.crystalaudio.gr



DECLARATION OF CONFORMITY

Radio equipment and telecommunications terminal equipment, Directive 2014/35/EU

Crystal Audio hereby declares that the product, CASB360 Wireless Soundbar, is in conformity with provisions of the Directive 2014/35/EU. The complete text of the Declaration of conformity can be found on the following webpage:

www.CrystalAudio.gr

Warranty:

The product has 2-years warranty starting from the purchase date and is only valid with the proof of purchase (receipt or invoice).

The warranty covers only the repair or replacement of the device and is effective only in Greece.

Damkalidis S.A. 44 Zefyrou str., P. Faliro, Greece

Designed in Europe by Crystal Audio-Assembled in China with the highest quality standards.



Auto Standby & Energy Saving

- The unit will automatically turn to standby mode when no audio input is received for 20 minutes. The soundbar will wake up from standby mode when any button is pressed or an input source is received.
- Please turn the unit off completely to save energy when not in use.
- To switch the unit off completely, remove the mains plug from the mains socket.

Input Modes

- Press the **INPUT** button repeatedly on the soundbar or press the INPUT button on the remote control to select the BT, AUX, OPTICAL, HDMI ARC, HDMI 1, HDMI 2, USB mode. The selected mode will show on the display.
- Below are input mode names appearing in the soundbar display:
bLUE-Bluetooth Pairing mode, RUX-AUX mode, OPTI-Optical mode, Hd 1-HDMI 1 mode, Hd 2-HDMI 2 mode, ARC - HDMI (ARC) OUT mode, USB-USB mode

The HDMI and HDMI (ARC) ports support Video & Audio

Video supported formats: 1080p / 4K / HDR / 60fps

Audio supported formats: Dolby Atmos, Dolby Digital, Dolby Digital Plus, Dolby TrueHD, Dolby Surround
HDMI version: 2.0

Bluetooth Connection



Through Bluetooth, connect the Soundbar with your Bluetooth device (such as smartphones, tablets, MP3 players or laptops), and then you can listen to the audio files stored on the device through your Soundbar.

What you need

- A Bluetooth device which supports Bluetooth profile A2DP, AVRCP and with Bluetooth version as 5.0.
- The maximum operational range between the Soundbar and a Bluetooth device is approximately 10 meters (30 feet).

- Turn on the soundbar and short-press **INPUT** button repeatedly on the unit or **INPUT** button on the remote control to switch the soundbar to Bluetooth model and LED display bLUE on the soundbar will flicker in the Bluetooth pairing mode.
- On the Bluetooth device, switch on Bluetooth, search for and select "CASB360" on your Bluetooth list to start connection (see the user manual of the Bluetooth device on how to enable Bluetooth) if prompted for a password, please use "0000".
- Wait until you hear the voice prompt from the Soundbar. If they successfully connect, bLUE stops flashing and remains displayed on the display panel.

- Select and play audio files or music on your Bluetooth device.
 - During play, if a call is coming, music playback is paused. Play resumes when the call ends
 - If your Bluetooth device supports AVRCP profile, on the remote control you can press **⏮** **⏭** to skip to a track, or short-press **⏸** to pause/resume play; Press and hold the **RESET** button more than 2 seconds to restore to factory default settings; Hold **Pair** button on the remote control for more than 2 seconds to disconnect paired BT device or connect back last disconnected BT device.
- You can use the volume buttons on the soundbar or on the remote controller to adjust the volume to your requirements
- To exit Bluetooth, select other relevant input source.
 - When your switch back to Bluetooth mode, Bluetooth connection remains active.
- Press the **VOL +/-** buttons to adjust the volume to your desired level.

Notes:

- Having connection problems? Remove CASB360 from your device's Bluetooth history and ensure it's less than 10 meters away. Then try pairing again. To get the best sound quality, make sure there is a clear line of sight between the connected device and your soundbar.
- If your pairing device or connected device is switched off or manual disconnected, the soundbar will automatically enter pairing mode.
- The music streaming may be interrupted by obstacles between the device and Soundbar, such as wall, metallic casing that covers the device, or other devices nearby that operate in the same frequency.
- If you want to connect your Soundbar with another Bluetooth device, press and hold Pair on the remote control to disconnect the currently connected Bluetooth device.

★ Connections

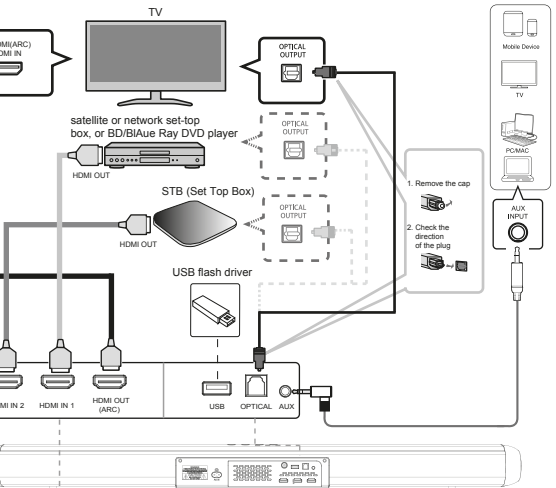

Playing Audio via USB Port

The soundbar automatically switches to USB input mode with the LED display USB when a USB flash drive is inserted (this mode isn't selectable on the soundbar or remote control unless a USB flash drive is connected).

- Ensure that your USB flash drive contains MP3 or WMA audio files (other file types not supported)
- Connect the USB flash drive to the USB port on the soundbar (or your own USB extension cable connected to the USB port); music will automatically play with LED display "00:00", when music is played on, the play time will be automatically displayed on the screen.
- Press the **VOL +/-** buttons to adjust the volume to your desired level
- During playback:



Playing Audio via AUX input Connection

- Use a 3.5mm to 3.5mm audio cable (included) to connect the PC, tablet, smartphone, TV's headphone socket to the AUX socket on the soundbar.
- Use an RCA to 3.5mm audio cable (not included) to connect a Blu Ray / DVD Player / TV's audio output sockets to the AUX socket on the soundbar.
- Then short-press the **INPUT** button on the soundbar or on the remote controller to switch to audio input mode with LED display lighting up RUX.
- In this mode, playback can only be controlled on your connected device

Note: For some computer, you may need to access the audio control panel to manually set the soundbar as above picture.

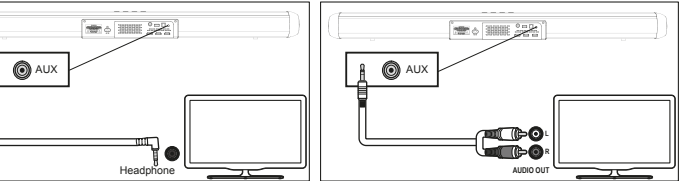

Optical Mode

Using an optical cable, connect the OPTICAL connector on your Soundbar (Optical digital input) to the OPTICAL OUT connector on the TV or other device. The TV or other device must have an optical digital output.

Proceed as follows:

- Connect the optical cable to the OPTICAL jack on the rear of the soundbar.
- Connect the other end of the optical cable to audio output jack on TV or other device.
- Set TV to PCM Stereo or Stereo 2.0.

- Start playing on the TV
- Press the source input button on the soundbar or remote control to activate the corresponding mode (the OPTICAL mode) to open optical digital input of your soundbar. After successfully connected, the LED display will show **OPTI**. Operate your audio device directly for playback features.
- Press the **VOL +/-** buttons to adjust the volume to your desired level.

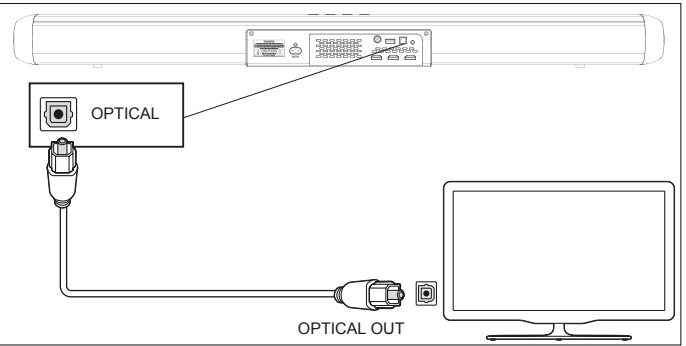

HDMI IN & HDMI (ARC) MODE

Connect to HDMI (ARC) Socket

Some 4K HDR TVs require the HDMI input or picture settings to be set for HDR content reception. For further setup details on HDR display, please refer to the instruction manual of your TV.

★ Option 1: ARC (Audio Return Channel)

- Your Soundbar supports HDMI with Audio Return Channel (ARC). If your TV is HDMI ARC compliant, you can hear the TV audio through your Soundbar by using a single HDMI cable.
- Use a High Speed HDMI cable, connect HDMI OUT (ARC) on the soundbar to HDMI (ARC) connector on your TV.
- Then short-press **INPUT** button on the sound bar or **INPUT** button on the remote controller to switch to HDMI (ARC) mode. After successfully connected, the LED display will show **ARC**.
- Press the **VOL +/-** buttons to adjust the volume to your desired level.
- If you wish, you can change the audio settings by using the relevant buttons on the remote controller.

★ Note:

- Your TV must support the HDMI-CEC and ARC function. HDMI-CEC and ARC must be set to be on
- The setting method of HDMI-CEC and ARC may differ depending on the TV. For details about ARC function, please refer to your TV owner's manual.
- Only HDMI 1.4 compatible cables can support the ARC function
- The Audio Return Channel (ARC) function enables an HDMI compatible TV to send the audio stream to HDMI OUT of the unit.

★ Option 2: Standard HDMI

- If your TV is not HDMI ARC-compliant, connect your soundbar to the TV through a standard HDMI connection.
- Use an HDMI cable (included) to connect the soundbar's HDMI OUT socket to the TV's HDMI IN socket.
- Use an HDMI cable (not included) to connect the soundbar's HDMI IN (1 or 2) socket to your external devices (e.g. games consoles, DVD players and Blue-Ray).
- Then short-press **INPUT** button on the soundbar or on the remote controller to switch to HDMI mode. After successfully connected, the LED display will show **Hd 1** or **Hd 2**.

★ HDMI Connections:

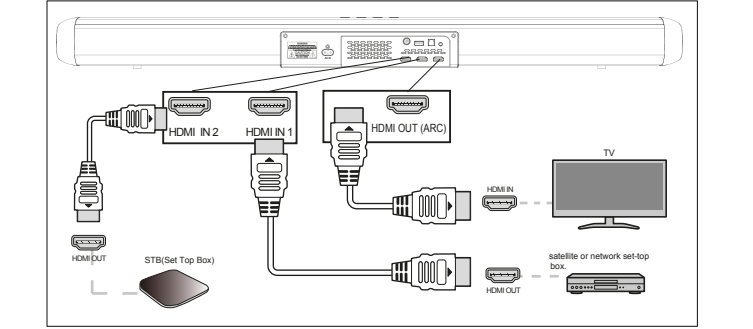

★ TIPS: (OPTICAL / HDMI ARC / HDMI 1 / HDMI 2 / DOLBY ATMOS)

- While in OPTICAL / HDMI ARC mode, if there's no sound output from the unit and the status LED display flashes, you may need to activate PCM or Dolby Digital Signal output on your source device (e.g. TV, DVD or Blu-ray player).
- The unit may not be able to decode all digital audio formats from the input source. In this case, the unit will. This is NOT a defect. Ensure that the audio setting of the input source (e.g. TV, game console, DVD player, etc.) is set to PCM or Dolby Digital (Refer to the user manual of the input source device for its audio setting details) with HDMI 1 / HDMI 2 / HDMI ARC / optical input.
- In HDMI mode, when DOLBY ATMOS audio format is entered, the Soundbar display shows DOLBY ATMOS.
- When DOLBY DIGITAL PLUS audio format is entered, the Soundbar display shows DOLBY SURROUND.

Troubleshooting

Remote control

Problem	Cause	Remedy
The unit cannot be operated using the remote control.	The unit is out of the operating range. The batteries are weak. The remote control sensor of the unit is exposed to direct sunlight or strong lighting.	Use the remote control within the operating range. Replace with new batteries. Adjust the lighting angle, or reposition the unit.
The TV cannot be operated using the TV's remote control.	The unit is blocking the TV's remote control sensor.	Position the unit so that it does not obstruct the TV's remote control sensor.

Bluetooth

Problem	Cause	Remedy
The unit cannot be connected to a Bluetooth device.	Bluetooth is not selected as the input source. The unit is connected to a different Bluetooth device. The unit is too far away from the Bluetooth device. A device emitting electromagnetic waves (such as a microwave oven, a wireless device and so on) may be located nearby. The Bluetooth device you are using may not support the protocol. The connection profile registered in the Bluetooth device may not be functioning correctly for some reason.	Select Bluetooth as the input source. Unpair the Bluetooth device that is currently connected, and pair with the desired Bluetooth device. Move the Bluetooth device closer to this unit. Do not use this unit near devices that emit electromagnetic waves. Use a Bluetooth device that supports the protocol.
No sound can be heard, or the sound cuts off intermittently.	The volume on the Bluetooth device may be too low. Bluetooth is not selected as the input source. Playback on the device has not been performed. The sound output on the Bluetooth device may not be set to this unit. The connection to the Bluetooth device was cut off. The unit may be too far away from the Bluetooth device. A device emitting electromagnetic waves (such as a microwave oven, a wireless device and so on) may be located nearby.	Raise the volume on the Bluetooth device. Select Bluetooth as the input source. Perform playback on the device. Select this unit as the output destination on the Bluetooth device. Connect with the Bluetooth device one more time. Move the Bluetooth device near this unit. Do not use this unit near devices that emit electromagnetic waves.

Audio

Problem	Cause	Remedy
No sound.	Another input source is selected. The mute function is activated. The volume is too low. The power cable of the unit is not connected properly. Input jacks on a playback device are connected.	Select an appropriate input source. Cancel the mute function. Turn up the volume. Make sure that the power cable of the unit is connected to an AC wall outlet securely. Connect the input jack on the unit and the output jack on the playback device.
The volume decreases when the unit is turned on.	Signals that the unit cannot play back are being input. The automatic volume adjustment function is activated. To prevent excessive loudness, the unit automatically controls its volume within a certain level when the unit is turned on.	Change the digital audio output setting on the playback device to PCM. Turn up the volume as required.
No surround effect.	The volume is too low. The TV or playback device is set to output 2 channel audio (such as PCM) only. Sound is also heard from the TV built-in speakers. The listening position is too close to the unit.	Turn up the volume. Change the digital audio output setting on the TV or playback device to BitStream. Set the TV volume to minimum. The listening position should be at some distance from the unit.
Noise is heard.	The unit is too close to another digital or high-frequency device.	Move those devices away from the unit.

CRYSTALAUDIO

User Manual

Dolby ATMOS SOUNDBAR

CASB360



For every thrilling moment, experience cinematic sound from your sofa. This Dolby Atmos soundbar with wired subwoofer draws you deeper into the shows and movies you love. You'll hear the drama flow around you, and even overhead as channels reproduce height as well as depth, creating a virtual 3-dimensional surround sound. Whether it's spaceships flying overhead or the crowd in an arena, you'll feel as if you're there.